

Front Chainwheel
FC-M543-SK Silver Version
FC-M543-LK Black Version

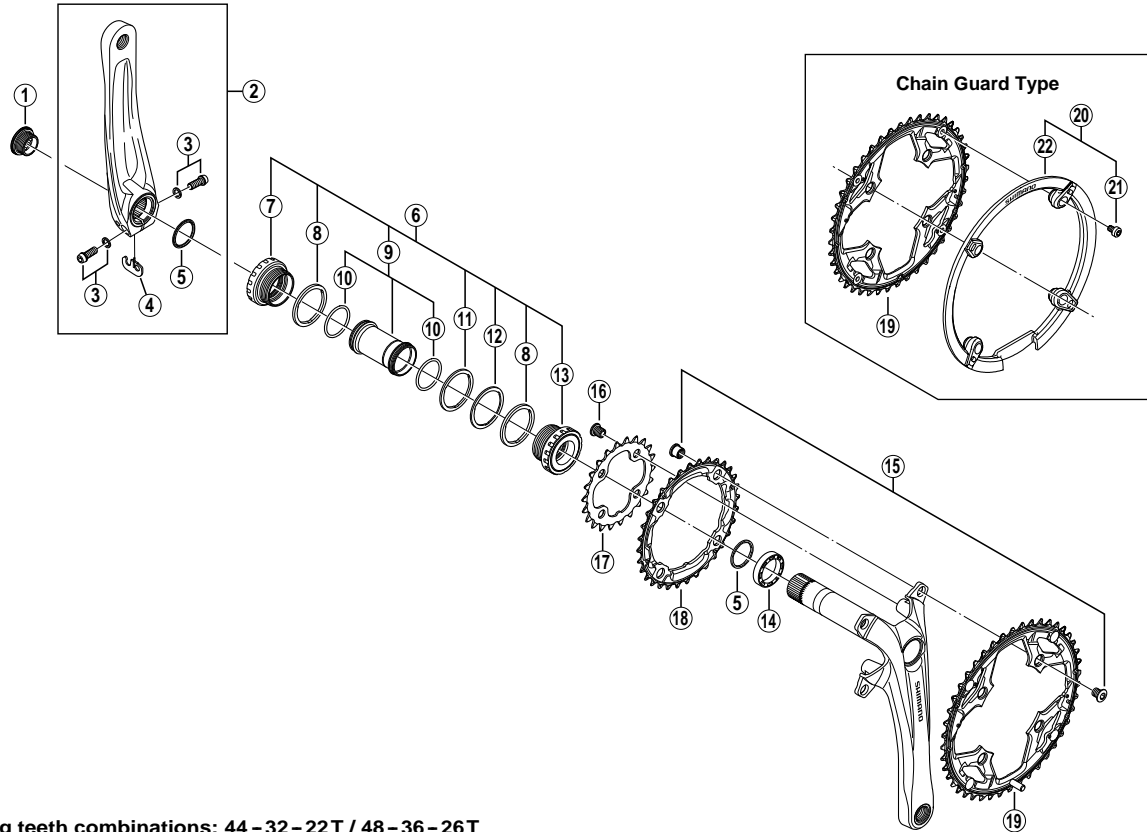

- Chaining teeth combinations: 44 – 32 – 22T / 48 – 36 – 26T
- Bolt circle diameter: 104 mm... (For outer gear and middle gear), 64 mm... (For inner gear)

ITEM NO.	SHIMANO CODE NO.	DESCRIPTION	INTERCHANGEABILITY
1	Y-1F8 11100	Crank Arm Fixing Bolt	A
2	Y-1JB 98010	Left Hand Crank Arm 170 mm (Silver) for FC-M543-SK	B
	Y-1JB 98020	Left Hand Crank Arm 170 mm (Black) for FC-M543-LK	B
	Y-1JB 98030	Left Hand Crank Arm 175 mm (Silver) for FC-M543-SK	B
	Y-1JB 98040	Left Hand Crank Arm 175 mm (Black) for FC-M543-LK	B
3	Y-1G3 98010	Clamp Bolt (M6 x 19) & Washer	A
4	Y-1FU 98120	Plate	A
5	Y-1F3 16000	Ring	A
6	Y-1J9 98050	Adapter Unit	A
7	Y-1FU 98090	Left Hand Adapter (B.C.1.37" x 24T) English Thread	A
8	Y-1F8 13000	Spacer (2.5 mm)	A
9	Y-1J8 98060	Inner Cover & O-Ring	A
10	Y-1TF 21000	O-Ring	A
11	Y-1F8 13100	Spacer (1.8 mm)	A
12	Y-1F8 13110	Spacer (0.7 mm)	A
13	Y-1FU 98100	Right Hand Adapter (B.C.1.37" x 24T) English Thread	A
14	Y-1F9 13000	Spacer (6.5 mm)	A
15	Y-1FM98020	Double Gear Fixing Bolt (M8 x 8.5) & Nut (4 sets)	A
16	Y-1FM98030	Inner Gear Fixing Bolt (M8 x 8.5 / 4 pcs.)	A
17	Y-1J8 22000	Chainring 22T (Silver)	A
	Y-1FV 26000	Chainring 26T (Silver)	A
18	Y-1FU 98020	Chainring 32T (Silver)	B
	Y-1FV 98010	Chainring 36T (Silver)	B
	Y-1JB 98050	Chainring 44T (Black)	B
19	Y-1JA 98060	Chainring 44T (Black) for Chain Guard	B
	Y-1JB 98060	Chainring 48T (Black)	B
	Y-1JB 98070	Chainring 48T (Black) for Chain Guard	B
20	Y-1J8 98090	Chain Guard for 44T & Fixing Bolts	A
	Y-1J8 98100	Chain Guard for 48T & Fixing Bolts	A
21	Y-1CY 98020	Chain Guard Fixing Bolt (4 pcs.)	A
22	Y-1GX 14000	Chain Guard for 44T	A
	Y-1GY 12000	Chain Guard for 48T	A

A: Same parts.
 B: Parts are usable, but differ in materials, appearance, finish, size, etc.
 Absence of mark indicates non-interchangeability.

FC-M533-K

0706-2682

Specifications are subject to change without notice.

SHIMANO