

DEORE LX Front Chainwheel FC-M583-K

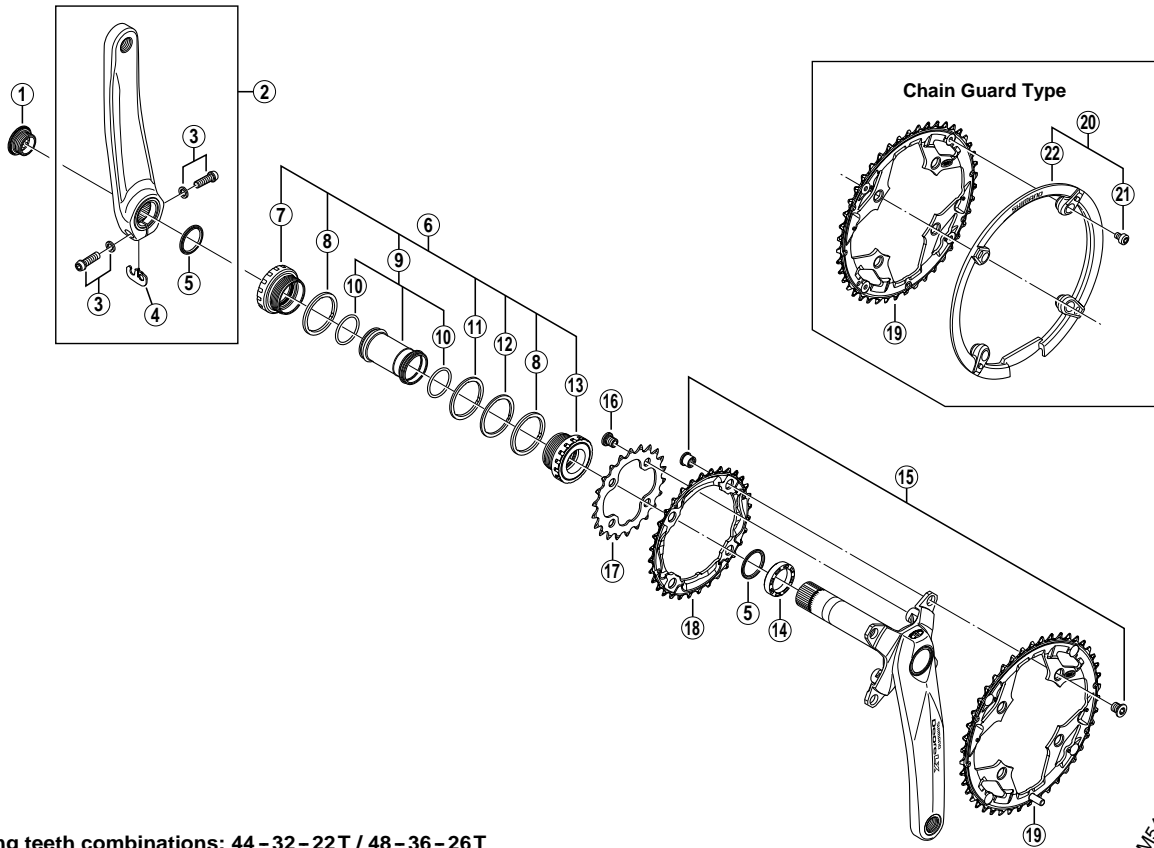

- Chaining teeth combinations: 44 – 32 – 22T / 48 – 36 – 26T
- Bolt circle diameter: 104 mm...(For outer gear and middle gear), 64 mm...(For inner gear)

FC-M543-K
FC-M581
FC-M580

ITEM NO.	SHIMANO CODE NO.	DESCRIPTION	INTERCHANGEABILITY
1	Y-1F8 11100	Crank Arm Fixing Bolt	A
2	Y-1JC 98010	Left Hand Crank Arm 170 mm	B B
	Y-1JC 98020	Left Hand Crank Arm 175 mm	B B
3	Y-1G3 98010	Clamp Bolt (M6 x 19) & Washer	A A A
4	Y-1FU 98120	Plate	A A A
5	Y-1F3 16000	Ring	A A A
6	Y-1FV 98060	Adapter Unit	B A A
7	Y-1FU 98090	Left Hand Adapter (B.C.1.37" x 24T) English Thread	A A A
8	Y-1F8 13000	Spacer (2.5 mm)	A A A
9	Y-1E5 98210	Inner Cover & O-Ring	B A A
10	Y-1TF 21000	O-Ring	A A A
11	Y-1F8 13100	Spacer (1.8 mm)	A A
12	Y-1F8 13110	Spacer (0.7 mm)	A A
13	Y-1FU 98100	Right Hand Adapter (B.C.1.37" x 24T) English Thread	A A A
14	Y-1F9 13000	Spacer (6.5 mm)	A A
15	Y-1C8 98010	Double Gear Fixing Bolt (M8 x 8.5) & Nut (4 sets)	B A A
16	Y-1BD98030	Inner Gear Fixing Bolt (M8 x 8.5 / 4 pcs.)	B A A
17	Y-1FU 22000	Chainring 22T (Silver)	B A
	Y-1FV 26000	Chainring 26T (Silver)	A A
18	Y-1FU 98020	Chainring 32T (Silver)	A A
	Y-1FV 98010	Chainring 36T (Silver)	A A
19	Y-1JD 98010	Chainring 44T (Black)	B A
	Y-1FU 98040	Chainring 44T (Black) for Chain Guard	B A
	Y-1FV 98020	Chainring 48T (Black)	B A
	Y-1FV 98030	Chainring 48T (Black) for Chain Guard	B A
20	Y-1GX98190	Chain Guard for 44T & Fixing Bolts	A A A
	Y-1GX98200	Chain Guard for 48T & Fixing Bolts	A A A
21	Y-1CY 98020	Chain Guard Fixing Bolt (4 pcs.)	A A A
22	Y-1F8 14000	Chain Guard for 44T	B A
	Y-1F9 12000	Chain Guard for 48T	B A

A: Same parts.

B: Parts are usable, but differ in materials, appearance, finish, size, etc.

Absence of mark indicates non-interchangeability.

0707-2686

Specifications are subject to change without notice.

SHIMANO